



# QUICK RELEASE COUPLINGS

ISO-A

ISO-B

Flat Faced

# Quick Release Couplings for the Industry



For fast and easy connections of hydraulic hoses, the Alfacomma range of fluid components includes this series of quick disconnect couplings complying to international standards ISO 7241-1 A/B and ISO 16028, with poppet and flat face valve respectively.

The standardised design assures the complete interchangeability with corresponding couplings currently in use.

Made from carbon steel as the basic material, Alfacomma couplings feature a chrome-free zinc plating with a long lasting resistance to oxidation.

The mechanical and fluid dynamic performance are maximised by means of specific geometries and surface treatments.

Extensive testing is carried out after production following the requirements of ISO 7241-2 standard.

ISO-A range includes is the true general purpose quick release coupling, with sizes from 1/4" to 2", BSPP and NPTF threaded connections and working pressure up to 350 bar.

Agricultural machinery is the main application for ISO-A couplings.

ISO-B series is more employed in the industrial sector (pressures can reach 380 bar), for equipment powered and controlled by hydraulic systems.

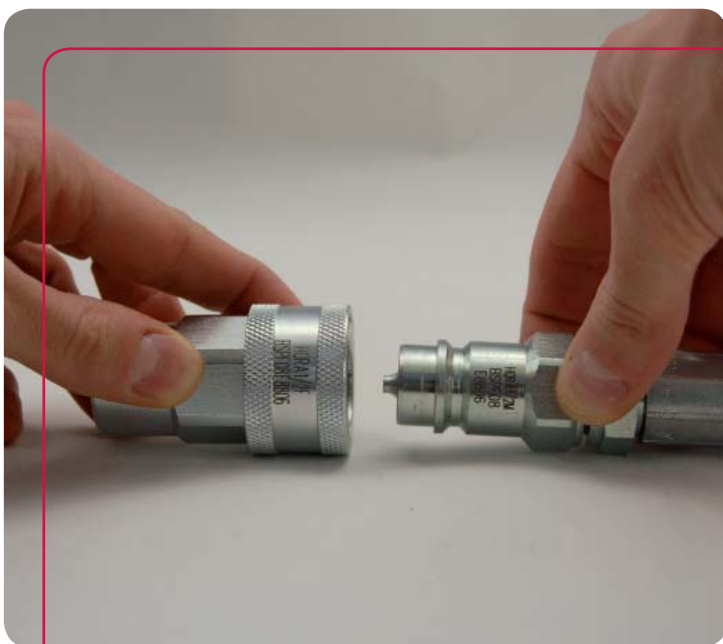

The Flat Faced range is the optimal choice to avoid circuit contamination and oil leakage when connecting and disconnecting.

Flat Faced Couplings are widely used on construction equipment, but also in hostile environments where spillage can constitute a danger. Flat face couplings have sizes from 1/4" to 2" and working pressure from 200 (2") to 300 bar (1/4").

Temperature range with standard seals (NBR) is -20 + 100°C.

Protective dust caps and plugs are available upon request, as well as further sizes and types, including multi-coupling systems.

The contents of this publication do not represent a guarantee of any kind and are subject to modification without prior notice.

**STANDARD ISO 7241 A - Poppet Valve  
FEMALE COUPLING - BSPP FEMALE (NPTF female also available)**

EQUIVALENT TO

Parker 660x  
Aeroquip FD56 (5600)  
Faster ANV (NV12)  
Stucchi BIR  
DNP PAV1  
Intertraco A

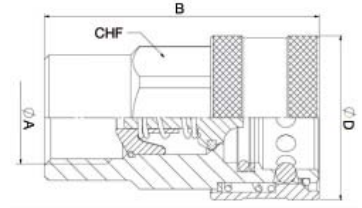

Code	Size	DN	Nominal Flow Rate	Max Working Pressure	Min Burst Pressure Connected	Min Burst Pressure	Thread A	B	Ø D	CHF
	inch	mm	l/min	MPa	MPa	MPa	inch	mm	mm	mm
R1QEPAF06F-0404	1/4	6,3	15	35	140	180	1/4	51,0	26,0	19
R1QEPAF06F-0606	3/8	10	35	30	120	135	3/8	58,5	32,0	24
R1QEPAF06F-0808	1/2	12,5	45	30	120	130	1/2	63,5	38,0	30
R1QEPAF06F-1212	3/4	20	74	25	100	120	3/4	83,5	46,0	38
R1QEPAF06F-1616	1	25	100	23	92	98	1	97,0	55,0	46
R1QEPAF06F-2020	1 1/4	32	118	23	92	95	1 1/4	117,0	70,0	50
R1QEPAF06F-2424	1 1/2	38	410	20	80	85	1 1/2	133,0	84,5	60
R1QEPAF06F-3232	2	51	860	13	52	65	2	165,0	100,0	75

**STANDARD ISO 7241 A - Poppet Valve  
MALE COUPLING - BSPP FEMALE (NPTF female also available)**

EQUIVALENT TO

Parker 660x  
Aeroquip FD56 (5600)  
Faster ANV (NV12)  
Stucchi BIR  
DNP PAV1  
Intertraco A

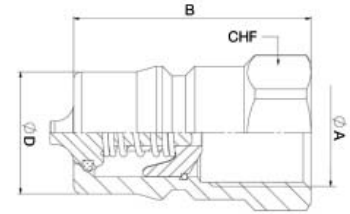

Code	Size	DN	Nominal Flow Rate	Max Working Pressure	Min Burst Pressure Connected	Min Burst Pressure	Thread A	B	Ø D	CHF
	inch	mm	l/min	MPa	MPa	MPa	inch	mm	mm	mm
R1QEPAM06F-0404	1/4	6,3	15	35	140	165	1/4	36,0	11,8	19
R1QEPAM06F-0606	3/8	10	35	30	120	125	3/8	40,5	17,3	22
R1QEPAM06F-0808	1/2	12,5	45	30	120	120	1/2	46,0	20,6	27
R1QEPAM06F-1212	3/4	20	74	25	100	103	3/4	56,0	29,0	36
R1QEPAM06F-1616	1	25	100	23	92	95	1	63,0	34,3	41
R1QEPAM06F-2020	1 1/4	32	118	23	92	80	1 1/4	75,0	45,0	50
R1QEPAM06F-2424	1 1/2	38	410	20	80	75	1 1/2	83,5	55,0	60
R1QEPAM06F-3232	2	51	860	13	52	62	2	105,0	65,1	75

**STANDARD ISO 7241 B - Poppet Valve  
FEMALE COUPLING - BSPP FEMALE (NPTF female also available)**

EQUIVALENT TO

Parker Hx-62 (60 ser.)  
Aeroquip FD45  
Faster HNV  
Stucchi IRB  
DNP PBV1  
Intertraco B

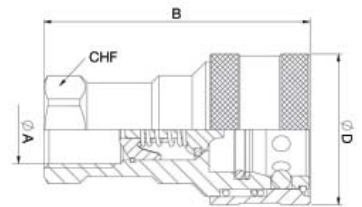

Code	Size	DN	Nominal Flow Rate	Max Working Pressure	Min Burst Pressure Connected	Min Burst Pressure	Thread A	B	Ø D	CHF
	inch	mm	l/min	MPa	MPa	MPa	inch	mm	mm	mm
R1QEPBF06F-0202	1/8	4	7	40	160	175	1/8	49,0	22,0	14
R1QEPBF06F-0404	1/4	6,3	15	38	152	180	1/4	57,7	27,0	19
R1QEPBF06F-0606	3/8	10	35	35	140	158	3/8	65,5	35,0	24
R1QEPBF06F-0808	1/2	12,5	47	32	128	145	1/2	74,0	42,0	27
R1QEPBF06F-1212	3/4	20	93	30	120	138	3/4	90,0	52,0	36
R1QEPBF06F-1616	1	25	118	28	112	140	1	103,0	60,0	41

**STANDARD ISO 7241 B - Poppet Valve**  
**MALE COUPLING - BSPP FEMALE (NPTF female also available)**

EQUIVALENT TO

Parker Hx-63 (60 ser.)  
 Aeroquip FD45  
 Faster HNV  
 Stucchi IRB  
 DNP PBV1  
 Intertraco B

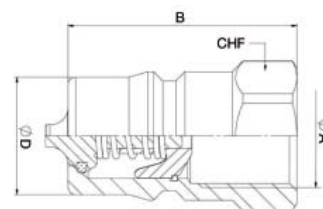

Code	Size	DN	Nominal Flow Rate	Max Working Pressure	Min Burst Pressure Connected	Min Burst Pressure	Thread A	B	Ø D	CHF
	inch	mm	l/min	MPa	MPa	MPa	inch	mm	mm	mm
R1QEPBM06F-0202	1/8	4	7	40	160	165	1/8	30,0	10,9	14
R1QEPBM06F-0404	1/4	6,3	15	38	152	165	1/4	36,0	14,2	19
R1QEPBM06F-0606	3/8	10	35	35	140	158	3/8	40,5	19,1	24
R1QEPBM06F-0808	1/2	12,5	47	32	128	131	1/2	46,0	23,6	27
R1QEPBM06F-1212	3/4	20	93	30	120	131	3/4	56,0	31,5	36
R1QEPBM06F-1616	1	25	118	28	112	120	1	63,0	37,8	41

**STANDARD ISO 16028 - Flat Face**  
**FEMALE COUPLING - BSPP FEMALE (NPTF female also available)**

EQUIVALENT TO

Parker FE (FF 3/8)  
 Aeroquip FD89 (FD49 3/8)  
 Faster 2FFI (2FFN38)  
 Stucchi FIRG  
 DNP PLT4  
 Intertraco F

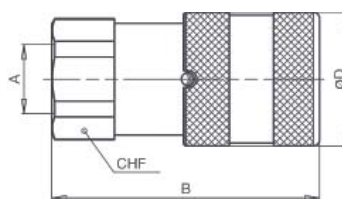

Code	Size	DN	Nominal Flow Rate	Force to Connect	Max Working Pressure	Min Burst Pressure Connected	Min Burst Pressure	Thread A	B	Ø D	CHF
	inch	mm	l/min	N	MPa	MPa	MPa	inch	mm	mm	mm
R1QFDEF06F-0404	1/4	6,3	12	140	12	120	48	1/4	48,1	28,0	22
R1QFDEF06F-0606	3/8	10	23	150	12	120	48	3/8	64,2	32,0	27
R1QFDEF06F-0608	3/8	10	23	150	12	120	48	1/2	69,2	32,0	27
R1QFDEF06F-0808	1/2	12,5	45	160	10	100	40	1/2	73,8	38,0	32
R1QFDEF06F-0812	1/2	12,5	45	160	10	100	40	3/4	80,8	38,0	36
R1QFDEF06F-1012	5/8	16	74	180	10	100	40	3/4	78,5	42,0	36
R1QFDEF06F-1212	3/4	19	100	270	33	100	100	3/4	88,7	48,0	41
R1QFDEF06F-1216	3/4	19	100	240	10	100	40	1	93,2	48,0	45
R1QFDEF06F-1620	1	25	189	310	10	100	40	1 1/4	106,0	55,0	55
R1QFDEF06F-2424	1 1/2	38	288	390	8	80	32	1 1/2	132,4	80,0	65
R1QFDEF06F-3232	2	51	379	470	8	80	32	2	156,6	100,0	80

**STANDARD ISO 16028 - Flat Face**  
**MALE COUPLING - BSPP FEMALE (NPTF female also available)**

EQUIVALENT TO

Parker FE (FF 3/8)  
 Aeroquip FD89 (FD49 3/8)  
 Faster 2FFI (2FFN38)  
 Stucchi FIRG  
 DNP PLT4  
 Intertraco F

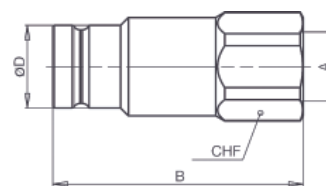

Code	Size	DN	Nominal Flow Rate	Force to Connect	Max Working Pressure	Min Burst Pressure Connected	Min Burst Pressure	Thread A	B	Ø D	CHF
	inch	mm	l/min	N	MPa	MPa	MPa	inch	mm	mm	mm
R1QFDEM06F-0404	1/4	6,3	12	140	42	120	126	1/4	47,9	16,1	22
R1QFDEM06F-0606	3/8	10	23	150	30	120	120	3/8	60,0	19,7	24
R1QFDEM06F-0608	3/8	10	23	150	30	120	120	1/2	62,5	19,7	27
R1QFDEM06F-0808	1/2	12,5	45	160	25	100	100	1/2	68,0	24,5	32
R1QFDEM06F-0812	1/2	12,5	45	160	25	100	100	3/4	70,5	24,5	36
R1QFDEM06F-1012	5/8	16	74	180	22	100	88	3/4	70,5	27,0	36
R1QFDEM06F-1212	3/4	19	100	270	33	100	100	3/4	82,3	30,0	41
R1QFDEM06F-1216	3/4	19	100	240	20	100	80	1	82,3	30,0	45
R1QFDEM06F-1620	1	25	189	310	20	100	80	1 1/4	89,8	36,0	55
R1QFDEM06F-2424	1 1/2	38	288	390	27	80	80	1 1/2	111,1	57,0	65
R1QFDEM06F-3232	2	51	379	470	16	80	64	2	123,8	73,0	75